

## **PROPOSED INTRODUCTION OF TRAFFIC RESTRICTIONS, WAITING AND LOADING RESTRICTIONS AND CONSTRUCTION OF ROAD HUMPS BETWEEN ENFIELD TOWN AND PONDERS END**

Further information may be obtained on the project page:

<https://letstalk.enfield.gov.uk/enfieldtown-pondersendstation>

**1. NOTICE IS HEREBY GIVEN** that the Council of the London Borough of Enfield (the Council), propose to make The Enfield (Prescribed Routes) (No. \*) Traffic Order 202\*, The Enfield (Waiting and Loading Restriction) (Amendment No. \*) Order 202\* and The Enfield (20 m.p.h. Speed Limit) (No. \*) Traffic Order 202\* under sections 6, 84 and 124 of and Part IV of Schedule 9 to the Road Traffic Regulation Act 1984, as amended.

**2.** The general effect of the Orders would be to:

- (a) impose a one-way working in (i) the length of Eaton Road that lies between its junction with Southbury Road and its junction with Queens Road, with all vehicles required to proceed in a northward direction except pedal cycles proceeding southward in the mandatory contraflow cycle lane; (ii) the length of Percival Road that lies between its junction with Lincoln Road and its junction with Bert Way, with all vehicles except pedal cycles required to proceed in a northward direction; and (iii) the length of Bertram Road that lies between its junction with Clive Way and its junction with Lincoln Road, with all vehicles except pedal cycles required to proceed in a southward direction;
- (b) ban all motor vehicles, except buses, proceeding in Southbury Road from entering Fotheringham Road;
- (c) in Cross Road, introduce a “no motor vehicles except buses” restriction at a point 6.8 metres west of the eastern property boundary of No. 99 Fotheringham Road, banning motor vehicles in the length of Cross Road that lies east of that point from entering the length of Cross Road that lies west of that point;
- (d) ban vehicles, except buses and pedal cycles, travelling in a southward direction in Fotheringham Road from turning right into Cross Road;
- (e) impose a 20 miles per hour speed limit in Bert Way, Bertram Road, Clive Road, Clive Way and Percival Road;
- (f) ban waiting at any time (to be indicated by double yellow lines) in the following lengths of road:- (i) Bert Way, on both sides at its junction with Percival Road; (ii) Cross Road, on both sides adjacent to and opposite the side of nos. 92 and 99 Fotheringham Road; (iii) Eaton Road (1) on the west side opposite nos. 2 to 6; (2) on the west side from opposite the side of no. 2A Queens Road to opposite the side of no. 1 Queens Road; (iv) Fotheringham Road, outside and opposite no. 90; and (v) Percival Road, on both sides outside and opposite nos. 73 to 83.
- (g) ban waiting, including waiting for the purposes of loading and unloading, at any time in (i) Eaton Road (1) on the west side, between the southern kerb-line of Southbury Road and a point 8.2 metres

south of that kerb-line; and (2) on the east side between its junction with Southbury Road and a point in line with the northern wall of No. 1 Queens Road; and (ii) Queens Road, on both sides, outside and opposite Nos. 2, 2A and 2B Queens Road.

**3. FURTHER NOTICE IS ALSO HEREBY GIVEN** that the Council of the London Borough of Enfield propose under section 90A of the Highways Act 1980, to:

- (a) construct road humps, with a maximum height of 100mm, in the following locations:- (i) Bertram Road outside (1) no. 41 and nos. 36 and 38; and (2) no. 131 and no. 126; (ii) Clive Road outside (1) no. 120 and nos. 111 and 113; (2) nos. 32 and 34 and nos. 27 and 29; and (iii) Percival Road outside (1) no. 24 and nos. 31 and 33; and (2) no. 118 and nos. 127 and 129 and
- (b) construct a flat-top road hump in the form of a continuous footway, in Fotheringham Road at its easternmost junction with Cross Road, extending for a total distance of 7.5 metres including the ramps.

**4.** A copy of the proposed Orders and of the Council's statement of reasons for proposing to make the Orders can be inspected at the Town Library, 66 Church Street, Enfield EN2 6AX, Monday to Fridays 9am – 5pm inclusive.

The notice, draft orders, and statement of reasons can also be inspected online at: <https://new.enfield.gov.uk/services/roads-and-transport/traffic-management-orders/>

Copies of the notice, draft order and Statement of reasons can also be obtained by emailing [journeysandplaces@enfield.gov.uk](mailto:journeysandplaces@enfield.gov.uk) or by writing to Traffic and Transportation, Civic Centre, Silver Street, Enfield, Middlesex, EN1 3XD (quoting reference TG52/1571).

**5.** Persons desiring to object to the proposed Orders or make any other representations must do so by 8<sup>th</sup> December 2024. Any such objection or any representation must be in writing, quoting reference TG52/1571, and must state the grounds on which it is made. Objections or representations can be made in any of the following ways:

- online via the consultation survey on the project page at <https://letstalk.enfield.gov.uk/enfieldtown-pondersendstation>
- emailed to: [JourneysandPlaces@enfield.gov.uk](mailto:JourneysandPlaces@enfield.gov.uk); or
- posted to: Journeys and Places Team, Enfield Council, Silver Street, Enfield, EN1 3XA.

Dated 13 November 2024

David B. Taylor  
Head of Highways, Traffic and Parking

The Enfield (Prescribed Routes) (No. \*) Traffic Order 202\*  
The Enfield (Waiting and Loading Restriction) (Amendment No. \*) Order 202\*  
The Enfield (20 m.p.h. Speed Limit) (No. \*) Traffic Order 202\*

### **STATEMENT OF REASONS**

Enfield Council is developing a network of active travel routes in Enfield to encourage more people to walk and cycle in the borough. Enfield Council is proposing a walking and cycling route from Enfield Town to Ponders End Station and these traffic orders are required to support the proposed route, which aims to:

- Expand the active travel network in the Borough and create an east to west link that would connect to the Ponders End High Street Improvements project (cycleway 1) and the future Enfield Town improvements project.
- Create safer neighbourhoods for all road users to walk, wheel and cycle.
- Contribute towards a long-term increase in levels of active travel, both along the route and as part of the wider borough network.



## THE COUNCIL OF THE LONDON BOROUGH OF ENFIELD TRAFFIC MANAGEMENT ORDER

202\* No. \*\*

---

The Enfield (Prescribed Routes) (No. \*\*) Order 202\*

Made \*\* \*\*\*\*\* 202\*

Coming into operation \*\* \*\*\*\* 202\*

---

The Council of the London Borough of Enfield, after consulting the Commissioner of Police of the Metropolis, in exercise of the powers conferred by sections 6 and 124 of and Part IV of Schedule 9 to the Road Traffic Regulation Act 1984(a), and of all other powers thereunto enabling hereby make the following Order:-

1. This Order shall come into operation on \*\* \*\*\*\*\* 202\* and may be cited as the Enfield (Prescribed Routes) (No. \*\*) Order 202\*.

2. In this Order:-

"bus" has the same meaning as in the Traffic Signs Regulations and General Directions 2016(b).

"carriageway" has the same meaning as in section 329(1) of the Highways Act 1980(c);

"contraflow" has the same meaning as in Schedule 1 to the Traffic Signs Regulations and General Directions 2016;

"Council" means the Council of the London Borough of Enfield;

"driver", in relation to a vehicle, has the same meaning as in section 142 of the Road Traffic Regulation Act 1984;

---

(a) 1984 c.27; (b) S.I. 2016/362; (c) 1980 c.66

"Eaton Road mandatory contraflow cycle lane" means a part of the carriageway within the length of Eaton Road that lies between its junction with Southbury Road and its junction with Queen's Road reserved for use by pedal cycles and which is separated from the rest of the carriageway by way of a road marking of the type shown in item 7 of Part 6 of Schedule 9 to the Traffic Signs Regulations and General Directions 2016;

"enactment" means any enactment, whether public general or local, and includes any order, bye-law, rule, regulation, scheme or other instrument having effect by virtue of an enactment and any reference in this Order to any enactment shall be construed as a reference to that enactment as amended, applied, consolidated, re-enacted by or as having effect by virtue of any subsequent enactment;

"pedal cycle" has the same meaning as in the Traffic Signs Regulations and General Directions 2016; and

"vehicle" includes any part of a vehicle.

### Prohibited Turns

3. (1) Except as provided in Article 8(1), no person causing any vehicle other than a pedal cycle to proceed in Queen's Road shall, upon reaching its junction with Eaton Road, cause or permit that vehicle to turn left into Eaton Road.
- (2) Except as provided in Article 8(1), no person causing any vehicle other than a bus or pedal cycle to proceed in Fotheringham Road in a southward direction shall, upon reaching its junction with Cross Road, cause or permit that vehicle to turn right into Cross Road.
- (3) Except as provided in Article 8(1), no person causing any vehicle other than a pedal cycle to proceed in Bert Way shall, upon reaching its junction with Percival Road, cause or permit that vehicle to turn left into Percival Road.
- (4) Except as provided in Article 8(1), no person causing any vehicle other than a pedal cycle to proceed in Lincoln Road in an eastward direction shall, upon reaching its junction with Bertram Road, cause or permit that vehicle to turn left into Bertram Road.
- (5) Except as provided in Article 8(1), no person causing any vehicle other than a pedal cycle to proceed in Lincoln Road in a westward direction shall, upon reaching its junction with Bertram Road, cause or permit that vehicle to turn right into Bertram Road.

### Compulsory Movements

4. (1) Except as provided in Article 8(1), every person causing or permitting any vehicle other than a pedal cycle to proceed in Percival Road in a southward direction must, on reaching its junction with Bert Way, cause that vehicle to turn left into Bert Way.

- (2) Except as provided in Article 8(1), every person causing or permitting any vehicle other than a pedal cycle to proceed in Bert Way must, on reaching its junction with Percival Road, cause that vehicle to turn right into Percival Road.

#### One-way traffic working

5. (1) Every person causing any vehicle to enter or proceed in the length of Eaton Road that lies between its junction with Southbury Road and its junction with Queen's Road shall cause that vehicle to proceed in a northward direction.

Provided that nothing in the preceding paragraph shall apply to a pedal cycle entering into or proceeding in the Eaton Road mandatory contraflow cycle lane.

- (2) Every person causing or permitting any vehicle other than a pedal cycle to enter or proceed in the length of Percival Road that lies between its junction with Lincoln Road and its junction with Bert Way shall cause that vehicle to proceed in a northward direction.
- (3) Every person causing or permitting any vehicle other than a pedal cycle to enter or proceed in the length of Bertram Road that lies between its junction with Clive Way shall cause that vehicle to proceed in a southward direction.

#### Prohibition of motor vehicles

6. (1) Except as provided in Article 8(1), no person shall cause or permit any motor vehicle other than a bus proceeding in Southbury Road to enter into Fotheringham Road.
- (2) Except as provided in Article 8(1), no person shall cause or permit any motor vehicle other than a bus proceeding in the length of Cross Road that lies east of a point 6.8 metres west of the eastern property boundary of No. 99 Fotheringham Road to enter into the length of Cross Road that lies west of that point.

#### Cycle lane

7. Except as provided in Article 8(2) and (3), no person shall cause or permit a vehicle other than a pedal cycle to be in the Eaton Road mandatory contraflow cycle lane.

#### Exemptions

8. (1) Nothing in Articles 3, 4, 5 or 6 of this Order shall apply:
  - (a) in relation to any vehicle being used for ambulance, fire brigade or police purposes; or
  - (b) in respect of any person who causes any vehicle to proceed in accordance with any restriction or requirement indicated by traffic signs

placed on the highway pursuant to section 66 or section 67 of the Road Traffic Regulation Act 1984; or

- (c) in respect of anything done with the permission or at the direction of a police constable in uniform or a civil enforcement officer.

Provided that the physical layout or design of the road, or of any structure or other feature or item of street furniture located in relation to that road, allows for such usage or passage of vehicles or such action without danger to other road users, or to the fabric of the road or such surrounding structures or features.

- (2) Nothing in Article 7 of this Order shall apply in respect of a vehicle entering into the Eaton Road mandatory contraflow cycle lane if it is safe and necessary to do so:

- (i) in order to pass a stationary vehicle;
- (ii) to enable the vehicle to enter, from the side of the road on which it is proceeding, land or premises adjacent to the length of road on which the line is placed, or another road joining that road;
- (iii) due to circumstances outside the control of the driver;
- (iv) in order to avoid an accident; or
- (v) for the purpose of complying with any direction of a police constable in uniform or a civil enforcement officer.

- (3) When a vehicle is being used for at least one of the purposes mentioned at sub-paragraph (4) of this Article and the observance of the prohibition in Article 7 would be likely to hinder the use of the vehicle for that purpose, then that prohibition does not apply to the driver of the vehicle.

- (4) The purposes are:

- (i) fire and rescue authority;
- (ii) ambulance;
- (iii) providing a response to an emergency at the request of an NHS ambulance service;
- (iv) bomb or explosive disposal;
- (v) special forces;
- (vi) police; and
- (vii) National Crime Agency.

Dated this \*\*\*\* day of \*\*\* 202\*.

Head of Highways, Traffic and Parking  
(The officer appointed for this purpose)







## THE COUNCIL OF THE LONDON BOROUGH OF ENFIELD TRAFFIC MANAGEMENT ORDER

202\* No. \*\*

---

The Enfield (Waiting and Loading Restriction)  
(Amendment No. \*\*\*) Order 202\*

Made \*\* \*\*\*\*\* 202\*

Coming into operation \*\* \*\*\*\*\* 202\*

---

The Council of the London Borough of Enfield, after consulting the Commissioner of Police of the Metropolis, in exercise of the powers conferred by sections 6 and 124 of and Part IV of Schedule 9 to the Road Traffic Regulation Act 1984(a), and of all other powers thereunto enabling hereby make the following Order:-

1. This Order shall come into operation on \*\* \*\*\*\*\* 202\* and may be cited as the Enfield (Waiting and Loading Restriction) (Amendment No. \*\*\*) Order 202\*.

3. In this Order the expression "enactment" means any enactment, whether public general or local, and includes any order, bye-law, rule, regulation, scheme or other instrument having effect by virtue of an enactment and any reference in this Order to any enactment shall be construed as a reference to that enactment as amended, applied, consolidated, re-enacted by or as having effect by virtue of any subsequent enactment.

9. Without prejudice to the validity of anything done or to any liability incurred in respect of any act or omission before the coming into operation of this Order, the Enfield (Waiting and Loading Restriction) Order 2012(b) shall have effect as though:-

- (a) for the items numbered 92, 156, 214, 746, 749, 1045 and 1739 in Schedule 1 to that Order there were substituted the items similarly numbered and set out in columns 1, 2 and 3 of Schedule 1 to this Order; and

(b) there were added to Schedule 2 to that Order the items numbered \*\*\*\* and \*\*\*\* and set out in columns 1, 2 and 3 of Schedule 2 to this Order.

Dated this \*\*\*\* day of \*\*\* 202\*.

Head of Highways, Traffic and Parking  
(The officer appointed for this purpose)



**SCHEDULE 1 (Continued)**

1	2	3
1045.	<p><b>Cross Road (Continued)</b></p> <p>(b) the south side (continued)</p> <p>(iii) between a point 13 metres west of the western kerb-line of the western arm of Fotheringham Road and a point 38.5 metres east of a point opposite the eastern kerb-line of the eastern arm of Fotheringham Road.</p>	A
92.	<p><b>Eaton Road</b></p> <p>(a) the east side</p> <p>(i) between the southern kerb-line of Southbury Road and a point 8 metres north of a point opposite the northern wall of Nos. 35-37 Eaton Road;</p> <p>(ii) between a point 8 metres north of a point opposite the northern wall of Nos. 35-37 Eaton Road and a point 9.5 metres north of the northern kerb-line of Seaford Road;</p> <p>(iii) between the northern kerb-line of Seaford Road and a point 9.5 metres north of that kerb-line;</p> <p>(b) the west side</p> <p>(i) between the southern kerb-line of Southbury Road and a point 8.5 metres south of that kerb-line;</p> <p>(ii) between a point 20.5 metres south of the southern kerb-line of Southbury Road and a point 3.6 metres north of a point opposite the southern property boundary of No. 12 Eaton Road</p> <p>(iii) between a point 2.4 metres south of the northern property wall of No. 2A Queen's Road and the northern kerb-line of the vehicular access to No. 33 Eaton Road</p> <p>(iv) between the southern kerb-line of the vehicular access to No. 33 Eaton Road and a point 9 metres north of the northern kerb-line of Seaford Road;</p>	<p>A</p> <p>F</p> <p>A</p> <p>A</p> <p>A</p> <p>F</p>

**SCHEDULE 1 (Continued)**

1	2	3
92.	<p><b>Eaton Road (continued)</b></p> <p>(b) the west side Continued)</p> <p>(v) between a point opposite the northern kerb-line of Seaford Road and a point 8.5 metres north of that kerb-line.</p>	A
746.	<p><b>Fotheringham Road</b></p> <p>(a) the east side</p> <p>(i) between the south-western kerb-line of Southbury Road and a point 15 metres north of the northern boundary of Nos. 1 and 2 Fotheringham Court, Fotheringham Road;</p> <p>(ii) between a point 0.8 metres south of the common boundary between Nos. 90 and 92 Fotheringham Road and a point 4.3 metres north of that boundary</p> <p>(iii) between the southern kerb-line of Cross Road and the common boundary of Nos. 94 and 96 Fotheringham Road;</p> <p>(iv) between the northern kerb-line of Lincoln Road and a point 11 metres north of that kerb-line;</p> <p>(b) the west side</p> <p>(i) between the south-western kerb-line of Southbury Road and a point 10 metres south of that kerb-line;</p> <p>(ii) between a point 2.2 metres south of the common boundary between Nos. 97 and 99 Fotheringham Road and a point 1.9 metres north of that boundary</p> <p>(iii) between the southern kerb-line of Cross Road and the common boundary of Nos. 101 and 103 Fotheringham Road;</p> <p>(iv) between the northern kerb-line of Lincoln Road, Enfield and a point 13metres north of that kerb-line.</p>	<p>A</p> <p>A</p> <p>A</p> <p>A</p> <p>A</p> <p>A</p> <p>A</p>

**SCHEDULE 1 (Continued)**

1	2	3
<b>156.</b>	<p><b>Lincoln Road</b></p> <p>(a) the north-west, north and north-east side</p> <p>(i) between the north-eastern kerb-line of the service road fronting the Nos. 70 and 106 London Road and a point 13 metres north-east of that kerb-line;</p> <p>(ii) between a point 13 metres north-east of the north-eastern kerb-line of the service road fronting the Nos. 70 and 106 London Road and a point 10 metres south-west of the south-western kerb-line of Chalkwell Park Avenue;</p> <p>(iii) between a point 10 metres south-west of the south-western kerb-line of Chalkwell Park Avenue and a point 15.8 metres north-east of the northeastern kerb-line of Chalkwell Park Avenue;</p> <p>(iv) between a point 15.8 metres northeast of the north-eastern kerb-line of Chalkwell Park Avenue and a point 14.02 metres south-west of the northwestern kerb-line of Lyndhurst Gardens;</p> <p>(v) between a point 14.02 metres southwest of the north-western kerb-line of Lyndhurst Gardens and a point 24.08 metres north-east of the southeastern kerb-line of Lyndhurst Gardens;</p> <p>(vi) between a point 24.08 metres northeast of the south-eastern kerb-line of Lyndhurst Gardens and a point 31.09 metres north-east of that kerb-line;</p> <p>(vii) between a point 31.09 metres northeast of the south-eastern kerb-line of Lyndhurst Gardens and a point 61.57 metres north-east of that kerb-line;</p> <p>(viii) between a point 61.57 metres northeast of the south-eastern kerb-line of Lyndhurst Gardens and a point 11.89 metres north-west of the southwestern kerb-line of Wellington Road;</p> <p>(ix) between a point 11.89 metres northwest of the south-western kerb-line of Wellington Road and the Enfield Town Railway Line level crossing;</p>	<p>A</p> <p>F</p> <p>A</p> <p>K</p> <p>F</p> <p>M</p> <p>F</p> <p>M</p> <p>F</p>

**SCHEDULE 1 (Continued)**

1	2	3
156.	<p><b>Lincoln Road (continued)</b></p> <p>(a ) the north-west, north and north-east side (continued</p> <p>(x) between a point 5 metres east of the common boundary of Nos. 64 and 66 Lincoln Road and the common boundary of Nos. 68 and 70 Lincoln Road;</p> <p>(xi) between a point 7 metres west of the western kerb-line of Fotheringham Road and a point 4 metres east of the eastern kerb-line of Fotheringham Road;</p> <p>(xii) between a point 29 metres east of the eastern kerblines of Fotheringham Road and a point 20 metres west of a point opposite the western kerblines of Hadrians Ride;</p> <p>(xiii) between a point 11.2 metres west of the western kerblines of Percival Road and a point 20 metres east of the eastern kerb-line of Percival Road;</p> <p>(xiv) between a point 24 metres north-west of the western kerb-line of Bertram Road and a point 9.5 metres southeast of the eastern kerb-line of Bertram Road;</p> <p>(xv) between a point 7 metres north-west of the western kerblines of Clive Road and the common boundary of Nos. 152 and 154 Lincoln Road;</p> <p>(xvi) between the common boundary of Nos. 162 and 164 Lincoln Road and a point 17.5 metres south-east of a point opposite the common boundary of Nos. 1 and 3 Southbury Avenue;</p> <p>(xvii) between a point 17.5 metres southeast of a point opposite the common boundary of Nos. 1 and 3 Southbury Avenue and the western kerb-line of Great Cambridge Road;</p> <p>(xviii) between a point 67.67 metres east of the eastern kerb-line of Great Cambridge Road and a point 13.5 metres east of the eastern side of the westernmost entrance to the Martinbridge Trading Estate, Lincoln Road;</p>	<p>A</p> <p>A</p> <p>A</p> <p>A</p> <p>A</p> <p>A</p> <p>A</p> <p>B</p> <p>A</p>

**SCHEDULE 1 (Continued)**

1	2	3
156.	<p><b>Lincoln Road (continued)</b></p> <p>(a ) the north-west, north and north-east side (continued</p> <p>(xix) between a point 8.5 metres west of the western kerb-line of the western arm of Lincoln Way and a point 4.5 metres west of the common boundary of Nos. 244 and 246 Lincoln Road;</p> <p>(xx) between the common boundary of Nos. 292 and 294 Lincoln Road and the common boundary of Nos. 338 and 340 Lincoln Road;</p> <p>(xxi) between a point opposite the common boundary of Nos. 361 and 363 Lincoln Road and the common boundary of Nos. 354 and 356 Lincoln Road;</p> <p>(xxii) between the common boundary of Nos. 460 and 462 Lincoln Road and a point 7 metres east of the eastern boundary of No.464 Lincoln Road;</p> <p>(xxiii) between a point 7 metres east of the eastern boundary of No. 464 Lincoln Road and the western kerb-line of High Street, Ponders End;</p> <p>(b) the south-east, south and south-west side</p> <p>(i) between the north-eastern kerb-line of London Road and a point 20 metres north-east of that kerb-line;</p> <p>(ii) between a point 20 metres north-east of the north-eastern kerb-line of London Road and a point opposite the northeastern wall of No. 4 Lincoln Road;</p> <p>(iii) between a point opposite the northeastern wall of No. 4 Lincoln Road and a point 15 metres west of the southwestern kerb-line of Wellington Road;</p> <p>(iv) between a point 15 metres west of the western kerb-line of Wellington Road and a point 10 metres east of the north-eastern kerb-line of Wellington Road;</p> <p>(v) between a point 10 metres east of the north-eastern kerb-line of Wellington Road and a point 39 metres east of that kerb-line;</p>	<p>A</p> <p>A</p> <p>A</p> <p>F</p> <p>A</p> <p>A</p> <p>F</p> <p>M</p> <p>A</p> <p>K</p>





**SCHEDULE 1 (Continued)**

1	2	3
156.	<p><b>Lincoln Road (continued)</b></p> <p>(b) the south-east, south and south-west side (continued)</p> <p>(xv) between a point opposite the party wall of Nos. 136 and 138 Lincoln Road and a point opposite the party wall of Nos. 138 and 140 Lincoln Road;</p> <p>(xvi) between a point 4.5 metres south-east of a point opposite the party wall of Nos. 148 and 150 Lincoln Road and a point 5 metres south-east of a point opposite the common boundary of Nos. 1 and 3 Southbury Avenue;</p> <p>(xvii) between a point opposite the party wall of Nos. 170 and 172 Lincoln Road and a point 5 metres south-east of a point opposite the common boundary of Nos. 1 and 3 Southbury Avenue;</p> <p>(xviii) between a point 18.50 metres south-east of a point opposite the common boundary of Nos. 1 and 3 Southbury Avenue southeastward for a distance of 10 metres;</p> <p>(xix) between a point 36 metres south-east of a point opposite the common boundary of Nos. 1 and 3 Southbury Avenue southeastward for a distance of 11 metres;</p> <p>(xx) between a point 30 metres north-west of the northern kerb-line of Main Avenue and a point 19 metres west of the western kerb-line of Great Cambridge Road;</p> <p>(xxi) between a point 67.5 metres south-east of the eastern kerb-line of Great Cambridge Road and a point 69 metres north-west of a point opposite the western wall of No. 244 Lincoln Road;</p> <p>(xxii) between a point 27 metres east of the eastern wall of No. 303 Lincoln Road and the common boundary of Nos. 341 and 343 Lincoln Road;</p> <p>(xxiii) between the common boundary of Nos. 345 and 347 Lincoln Road and the common boundary of Nos. 355 and 357 Lincoln Road;</p>	<p>A</p> <p>F</p> <p>A</p> <p>B</p> <p>B</p> <p>A</p> <p>A</p> <p>A</p> <p>A</p>

**SCHEDULE 1 (Continued)**

1	2	3
<b>156.</b>	<p><b>Lincoln Road (continued)</b></p> <p>(b) the south-east, south and south-west side (continued)</p> <p>(xxiv) between the common boundary of Nos. 369 and 371 Lincoln Road and the common boundary Of Nos. 373 and 375 Lincoln Road;</p> <p>(xxv) between a point 1 metre west of the easternmost wall of Nos. 1 to 6 Concord Road and a point 0.5 metres west of the common boundary of Nos. 413 and 415 Lincoln Road;</p> <p>(xxvi) between a point 5 metres north-east of the common boundary of Nos. 471 and 473 Lincoln Road and a point 7 metres east of the eastern boundary of No.464 Lincoln Road;</p> <p>(xxvii) between a point 7 metres east of the eastern boundary of No. 464 Lincoln Road and the western kerb-line of High Street, Ponders End and that kerb-line.</p>	<p>A</p> <p>A</p> <p>F</p> <p>A</p>
<b>214.</b>	<p><b>Queen's Road, Enfield</b></p> <p>(a) the north side</p> <p>(i) between the eastern kerb-line of Eaton Road to a point 2.5 metres east of the common boundary of Nos. 2b and 2 Queen's Road;</p> <p>(ii) between a point 2.5 metres east of the common boundary of Nos. 2b and 2 Queen's Road and a point 7 metres west of the western kerb-line of Stanley Road;</p> <p>(iii) between a point 7 metres west of the western kerb-line of Stanley Road and a point 7 metres east of the eastern kerb-line of Stanley Road;</p> <p>(iv) between a point 7 metres east of the eastern kerb-line of Stanley Road and its eastern extremity;</p>	<p>A</p> <p>F</p> <p>A</p> <p>A</p>

**SCHEDULE 1 (Continued)**

1	2	3
<b>214.</b>	<p><b>Queen's Road, Enfield</b></p> <p>(b) the south side</p> <p>(i) between the eastern kerb-line of Eaton Road to a point 1 metre east of the common boundary of Nos. 1 and 3 Queen's Road;</p> <p>(ii) between a point 1 metre east of the common boundary of Nos. 1 and 3 Queen's Road and its eastern extremity</p>	<p>A</p> <p>F</p>
<b>749.</b>	<p><b>Percival Road</b></p> <p>(a) the east side</p> <p>(i) between the south-western kerb-line of Southbury Road and a point 10 metres south of that kerb-line;</p> <p>(ii) between a point 3.1 metres north of the common boundary of Nos. 68 and 70 Percival Road and a point 3.1 metres south of the common boundary of Nos. 72 and 74 Percival Road;</p> <p>(iii) between the north-eastern kerb-line of Lincoln Road and the common boundary of Nos. 154 and 156 Percival Road;</p> <p>(b) the west side</p> <p>(i) between the south-western kerb-line of Southbury Road and a point 10 metres south of that kerb-line;</p> <p>(ii) between a point 0.7 metres south-east of the common boundary of Nos. 71 and 73 Percival Road and the common boundary of Nos. 83 and 85 Percival Road;</p> <p>(iii) between the north-eastern kerb-line of Lincoln Road and a point 8.4 metres north of that kerb-line.</p>	<p>A</p> <p>A</p> <p>A</p> <p>A</p> <p>A</p> <p>A</p>

## SCHEDULE 2

1	2	3
****.	<p><b>Eaton Road</b></p> <p>(a) the east side, between the southern kerb-line of Southbury Road and a point 8 metres north of a point opposite the northern wall of Nos. 35-37 Eaton Road;</p> <p>(b) the west side, between the southern kerb-line of Southbury Road and a point 8.5 metres south of that kerb-line.</p>	<p>1</p> <p>1</p>
****.	<p><b>Queen's Road, Enfield</b></p> <p>(a) the north side, between the eastern kerb-line of Eaton Road and a point 2.5 metres east of the common boundary of Nos. 2b and 2 Queen's Road;</p> <p>(b) the south side, between the eastern kerb-line of Eaton Road and a point 1 metre east of the common boundary of Nos. 1 and 3 Queen's Road.</p>	<p>1</p> <p>1</p>

### EXPLANATORY NOTE

This Order further amends the Enfield (Waiting and Loading Restriction) Order 2012, so as to introduce "at any time" waiting restrictions in Bert Way, Cross Road, Eaton Road, Fotheringham Road, Lincoln Road, Queen's Road and Percival Road and "at any time" loading restrictions in Eaton Road and Queen's Road in the London Borough of Enfield.

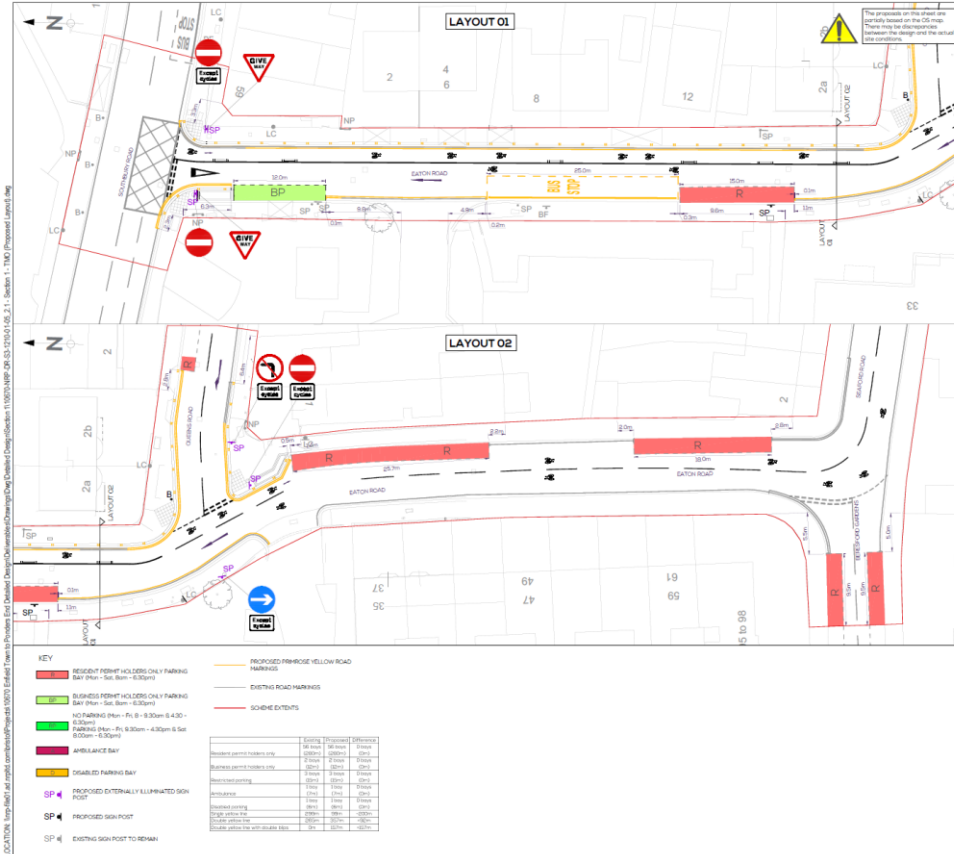

**KEY**

- RESIDENT PERMIT HOLDERS ONLY PARKING Bay (9m x 5.0m - 6.0m)
- BUSINESS PERMIT HOLDERS ONLY PARKING Bay (9m x 5.0m - 6.0m)
- NO PARKING (9m x 4.3m - 4.30m)
- NO PARKING (9m x 4.3m - 4.30m & 4.30m - 6.0m)
- AMBULANCE BAY
- DISABLED PARKING BAY
- PROPOSED EXTERNALLY ILLUMINATED SIGN POST
- PROPOSED SIGN POST
- EXISTING SIGN POST TO REMAIN

PROPOSED FRIMOUSE YELLOW ROAD MARKINGS

EXISTING ROAD MARKINGS

SCHEME EXTENTS

Existing	Proposed	Reference
Resident permit holders only	4.30m	2.00m
Business permit holders only	4.30m	2.00m
No parking	4.30m	2.00m
No parking	4.30m	2.00m
Ambulance	4.30m	2.00m
Disabled parking	4.30m	2.00m
Sign post	4.30m	2.00m
Sign post	4.30m	2.00m
Sign post	4.30m	2.00m

**NOTES**

1. ALL DIMENSIONS SHOWN ARE IN METRES UNLESS STATED OTHERWISE.
2. DO NOT SCALE FROM THIS DRAWING.
3. THIS DESIGN IS BASED ON A COMBINATION OF TOPOGRAPHICAL SURVEY AND ORDNANCE SURVEY. ANY DISCREPANCIES ARE TO BE REPORTED TO SITE ENGINEER.
4. ALL ROAD MARKINGS AND SIGNS TO BE IN ACCORDANCE WITH THE TRAFFIC SIGNS REGULATIONS AND GENERAL DIRECTIONS (TSRD) 2026 AND TRAFFIC SIGNS MANUAL 2026.

REV	DATE	DRAWN	REV'D	APP'D	NOTES
2.1	07/04	ES	LB	DV	EXISTING ROAD MARKINGS UPDATED.
2.0	06/04	ES	LB	DV	CHANGES REQUESTED BY CLIENT
1.0	03/04	CS	DV	DV	FIRST ISSUE

**DRAWING STATUS**

**FOR INFORMATION**

**NORMAN ROURKE PRYME**

**CLIENT**  
LONDON BOROUGH OF ENFIELD

**PROJECT**  
ENFIELD TOWN TO PONDERS END CYCLE ROUTE

ISSUE	ISSUED	REVIEWED	DATE	APPROVED	DATE
ES	CS	LB	07/04	DV	07/04

**TITLE**  
DETAILED DESIGN - TMO (PROPOSED LAYOUT)  
SECTION 1  
SHEET 01 OF 05

SCALE	DRAWING No	REV
1:2000A1	10670-NRP-DR-S3-1210-01	2.1



**KEY**

- RESIDENT PERMIT HOLDERS ONLY PARKING Bay (9m x 5.0m - 6.0m)
- BUSINESS PERMIT HOLDERS ONLY PARKING Bay (9m x 5.0m - 6.0m)
- NO PARKING (9m x 4.3m - 4.30m)
- NO PARKING (9m x 4.3m - 4.30m & 4.30m - 6.0m)
- AMBULANCE BAY
- DISABLED PARKING BAY
- PROPOSED EXTERNALLY ILLUMINATED SIGN POST
- PROPOSED SIGN POST
- EXISTING SIGN POST TO REMAIN

PROPOSED FRIMOUSE YELLOW ROAD MARKINGS

EXISTING ROAD MARKINGS

SCHEME EXTENTS

Existing	Proposed	Reference
Resident permit holders only	4.30m	2.00m
Business permit holders only	4.30m	2.00m
No parking	4.30m	2.00m
No parking	4.30m	2.00m
Ambulance	4.30m	2.00m
Disabled parking	4.30m	2.00m
Sign post	4.30m	2.00m
Sign post	4.30m	2.00m
Sign post	4.30m	2.00m

**NOTES**

1. ALL DIMENSIONS SHOWN ARE IN METRES UNLESS STATED OTHERWISE.
2. DO NOT SCALE FROM THIS DRAWING.
3. THIS DESIGN IS BASED ON A COMBINATION OF TOPOGRAPHICAL SURVEY AND ORDNANCE SURVEY. ANY DISCREPANCIES ARE TO BE REPORTED TO SITE ENGINEER.
4. ALL ROAD MARKINGS AND SIGNS TO BE IN ACCORDANCE WITH THE TRAFFIC SIGNS REGULATIONS AND GENERAL DIRECTIONS (TSRD) 2026 AND TRAFFIC SIGNS MANUAL 2026.

REV	DATE	DRAWN	REV'D	APP'D	NOTES
2.1	07/04	ES	LB	DV	EXISTING ROAD MARKINGS UPDATED.
2.0	06/04	ES	LB	DV	CHANGES REQUESTED BY CLIENT
1.0	03/04	CS	DV	DV	FIRST ISSUE

**DRAWING STATUS**

**FOR INFORMATION**

**NORMAN ROURKE PRYME**

**CLIENT**  
LONDON BOROUGH OF ENFIELD

**PROJECT**  
ENFIELD TOWN TO PONDERS END CYCLE ROUTE

ISSUE	ISSUED	REVIEWED	DATE	APPROVED	DATE
ES	CS	LB	07/04	DV	07/04

**TITLE**  
DETAILED DESIGN - TMO (PROPOSED LAYOUT)  
SECTION 1  
SHEET 02 OF 05

SCALE	DRAWING No	REV
1:2000A1	10670-NRP-DR-S3-1210-02	2.1



**NOTES**

1. ALL DIMENSIONS SHOWN ARE IN METRES UNLESS STATED OTHERWISE.
2. DO NOT SCALE FROM THIS DRAWING.
3. THIS DESIGN IS BASED ON A COMBINATION OF TOPOGRAPHICAL SURVEY AND ORDINANCE SURVEY. ANY DISCREPANCIES ARE TO BE REPORTED TO SITE ENGINEER.
4. ALL ROAD MARKINGS AND SIGNS TO BE IN ACCORDANCE WITH THE TRAFFIC SIGNS REGULATIONS AND GENERAL DIRECTIONS (TSRGD) 2026 AND TRAFFIC SIGNS MANUAL 2026.

REV	DATE	DRAWN	REV'D	APP'D	NOTES
2.1	07/02/24	ES	LB	DV	EXISTING ROAD MARKINGS UPDATED
2.0	06/01/24	ES	LB	DV	CHANGES REQUESTED BY CLIENT
1.0	03/03/24	CS	DV	DV	FIRST ISSUE

**DRAWING STATUS**

**FOR INFORMATION**

**NRP**  
NORMAN ROURKE PRYME

CLIENT: LONDON BOROUGH OF ENFIELD

PROJECT: ENFIELD TOWN TO PONDERS END CYCLE ROUTE

ISSUED	DESIGNED	REVISED	DATE	APPROVED	DATE
ES	CS	LB	07/02/24	DV	07/02/24

TITLE: DETAILED DESIGN - TMO (PROPOSED LAYOUT) SECTION 1 SHEET 03 OF 05

SCALE: 1:2000A1 DRAWING No: 10670-NRP-DR-S3-1210-03 REV: 2.1

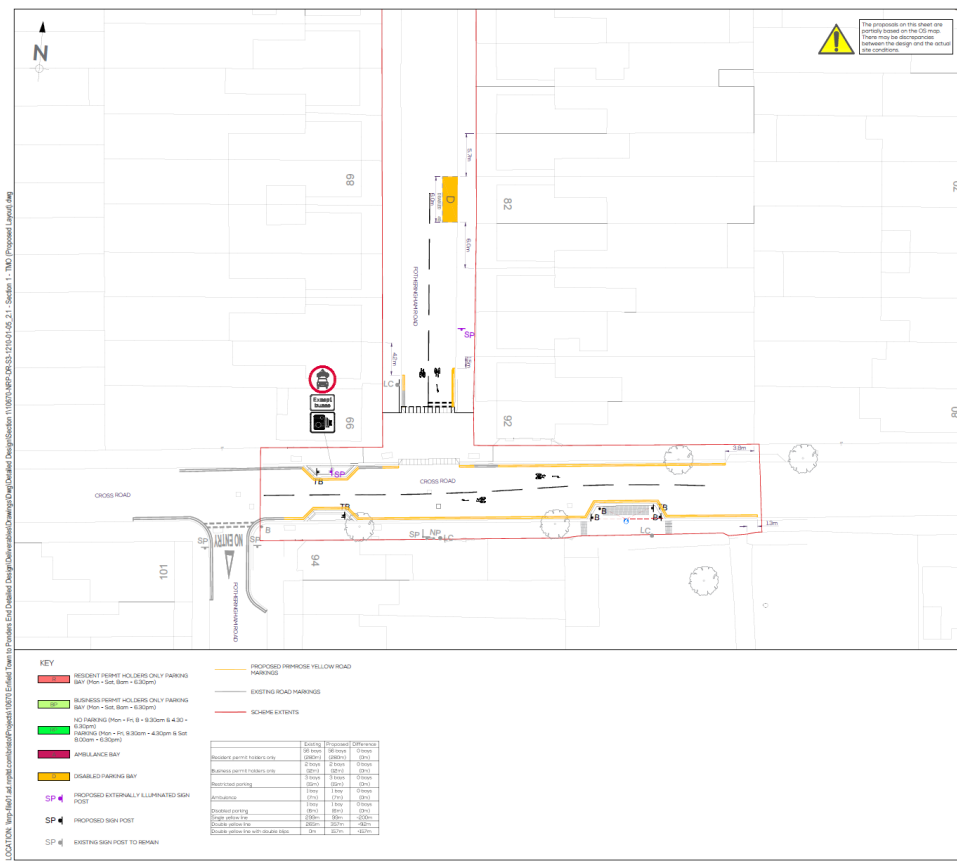

**NOTES**

1. ALL DIMENSIONS SHOWN ARE IN METRES UNLESS STATED OTHERWISE.
2. DO NOT SCALE FROM THIS DRAWING.
3. THIS DESIGN IS BASED ON A COMBINATION OF TOPOGRAPHICAL SURVEY AND ORDINANCE SURVEY. ANY DISCREPANCIES ARE TO BE REPORTED TO SITE ENGINEER.
4. ALL ROAD MARKINGS AND SIGNS TO BE IN ACCORDANCE WITH THE TRAFFIC SIGNS REGULATIONS AND GENERAL DIRECTIONS (TSRGD) 2026 AND TRAFFIC SIGNS MANUAL 2026.

REV	DATE	DRAWN	REV'D	APP'D	NOTES
2.1	07/02/24	ES	LB	DV	EXISTING ROAD MARKINGS UPDATED
2.0	06/01/24	ES	LB	DV	CHANGES REQUESTED BY CLIENT
1.0	03/03/24	CS	DV	DV	FIRST ISSUE

**DRAWING STATUS**

**FOR INFORMATION**

**NRP**  
NORMAN ROURKE PRYME

CLIENT: LONDON BOROUGH OF ENFIELD

PROJECT: ENFIELD TOWN TO PONDERS END CYCLE ROUTE

ISSUED	DESIGNED	REVISED	DATE	APPROVED	DATE
ES	CS	LB	07/02/24	DV	07/02/24

TITLE: DETAILED DESIGN - TMO (PROPOSED LAYOUT) SECTION 1 SHEET 04 OF 05

SCALE: 1:2000A1 DRAWING No: 10670-NRP-DR-S3-1210-04 REV: 2.1

LOCATION: 10670-NRP-DR-S3-1210-05\_2.1 - Section 1 - TMO (Proposed Layout)

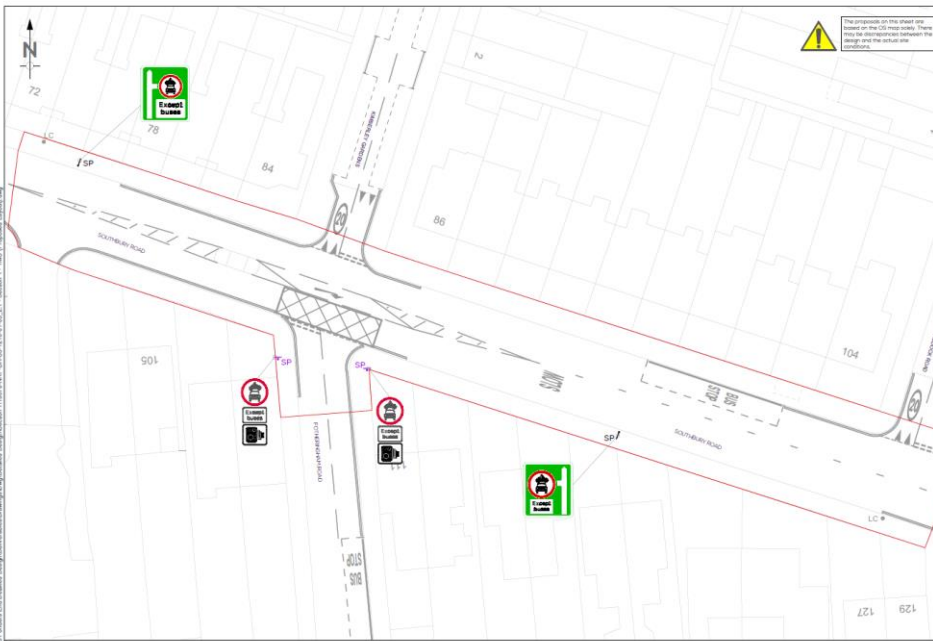

**KEY**

RESIDENT FRONT HOUSERS ONLY PARKING BAY (P18 + Sat Sun + 8.30am)	PROPOSED PRERHODE YELLOW ROAD MARKINGS
BUSINESS FRONT HOUSERS ONLY PARKING BAY (P18 + Sat Sun + 8.30am)	EXISTING ROAD MARKINGS
NO PARKING (P18 + P19 + 8.30am - 4.30pm + 4.30pm - 8.30pm + 8.30pm)	SCHEME EXTENTS
APPLIANCE BAY	
DISABLED PARKING BAY	
PROPOSED EXTERNALLY ILLUMINATED SIGN POST	
PROPOSED SIGN POST	
EXISTING SIGN POST TO REMAIN	

**NOTES**

1. ALL DIMENSIONS SHOWN ARE IN METRES UNLESS STATED OTHERWISE.
2. DO NOT SCALE FROM THIS DRAWING.
3. THIS DESIGN IS BASED ON A COMBINATION OF TOPOGRAPHICAL SURVEY AND ORDNANCE SURVEY. ANY DISCREPANCIES ARE TO BE REPORTED TO SITE ENGINEER.
4. ALL ROAD MARKINGS AND SIGNS TO BE IN ACCORDANCE WITH THE TRAFFIC SIGNS REGULATIONS AND GENERAL DIRECTIONS (TSRGD) 2008 AND TRAFFIC SIGNS MANUAL 2008.

REV	DATE	DRAWN	REV'D	APP'D	NOTES
01	20/04/04	ES	LB	DV	EXISTING ROAD MARKINGS UPDATED
02	06/05/04	ES	LB	DV	CHANGES REQUESTED BY CLIENT
03	03/05/04	CS	DV	DV	FIRST ISSUE

**FOR INFORMATION**

London: 17 Woodrow Street, London, SE1 2EP, UK  
Tel: 0207 367 1500  
Bristol: 4 Colston Avenue, Bristol, BS2 4BT, UK  
Tel: 01274 367 1500  
www.nrppl.com

**CLIENT**  
LONDON BOROUGH OF ENFIELD

**PROJECT**  
ENFIELD TOWN TO PONDERS END CYCLE ROUTE

ISSUED	REVISIONS	DATE	APPROVED	DATE
ES	LB	07/04/04	DV	07/04/04

**TITLE**  
DETAILED DESIGN - TMO (PROPOSED LAYOUT)  
SECTION 1  
SHEET 05 OF 05

SCALE	DRAWING No	REV
1:200 (A1)	10670-NRP-DR-S3-1210-05	2.1

LOCATION: 10670-NRP-DR-S3-1210-06\_2.1 - Section 2D - TMO (Proposed Layout)



**KEY**

DISABLED PARKING BAY	Existing	Proposed	Difference
DISABLED PARKING BAY	10 bays (60m)	10 bays (80m)	None
DOUBLE YELLOW LINE	72.9m	107.6m	+34.7m

**NOTES**

1. ALL DIMENSIONS SHOWN ARE IN METRES UNLESS STATED OTHERWISE.
2. DO NOT SCALE FROM THIS DRAWING.
3. THIS DESIGN IS BASED ON A COMBINATION OF TOPOGRAPHICAL SURVEY AND ORDNANCE SURVEY. ANY DISCREPANCIES ARE TO BE REPORTED TO SITE ENGINEER.
4. ALL ROAD MARKINGS AND SIGNS TO BE IN ACCORDANCE WITH THE TRAFFIC SIGNS REGULATIONS AND GENERAL DIRECTIONS (TSRGD) 2008 AND TRAFFIC SIGNS MANUAL 2008.

REV	DATE	DRAWN	REV'D	APP'D	NOTES
01	20/04/04	ES	LB	DV	EXISTING ROAD MARKINGS UPDATED
02	06/05/04	ES	LB	DV	SPEED LIMITS MODIFIED
03	04/05/04	ES	LB	DV	FIRST ISSUE

**FOR INFORMATION**

London: 17 Woodrow Street, London, SE1 2EP, UK  
Tel: 0207 367 1500  
Bristol: 4 Colston Avenue, Bristol, BS2 4BT, UK  
Tel: 01274 367 1500  
www.nrppl.com

**CLIENT**  
LONDON BOROUGH OF ENFIELD

**PROJECT**  
ENFIELD TOWN TO PONDERS END CYCLE ROUTE

ISSUED	REVISIONS	DATE	APPROVED	DATE
ES	LB	07/04/04	DV	07/04/04

**TITLE**  
DETAILED DESIGN - TMO  
SECTION 2D - PROPOSED LAYOUT  
SHEET 06 OF 15

SCALE	DRAWING No	REV
1:200 (A1)	10670-NRP-DR-S3-1210-06	2.1



LOGON NAME: ELLY.TREVENION  
 LOCATION: Enfield - proposed cycle route  
 Project Name: Enfield Town to Ponders End Cycle Route  
 Drawing Title: Detailed Design - TMO  
 Drawing No: 10670-NRP-DR-S3-1210-07

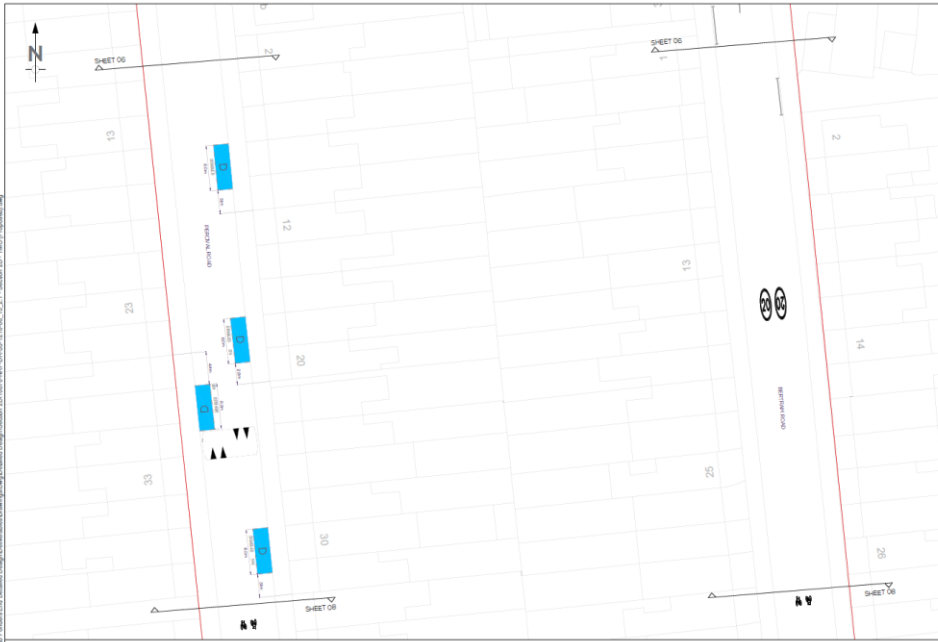

- KEY**
- DISABLED PARKING BAY
  - EXISTING ROAD MARKINGS
  - PROPOSED WHITE ROAD MARKINGS
  - PROPOSED PINKISH YELLOW ROAD MARKINGS
  - PROPOSED NEW SIGN AND POST
  - PROPOSED NEW ILLUMINATED SIGN AND POST
  - SCHEME EXTENTS

	Existing	Proposed	Difference
Disabled parking bay	30 bays (80m)	30 bays (80m)	None
Double yellow line	70.9m	107.6m	+34.7m

- NOTES**
1. ALL DIMENSIONS SHOWN ARE IN METRES UNLESS STATED OTHERWISE.
  2. DO NOT SCALE FROM THIS DRAWING.
  3. THIS DESIGN IS BASED ON A COMBINATION OF TOPOGRAPHICAL SURVEY AND CORDANCE SURVEY. ANY DISCREPANCIES ARE TO BE REPORTED TO SITE ENGINEERS.
  4. ALL ROAD MARKINGS AND SIGNS TO BE IN ACCORDANCE WITH THE TRAFFIC SIGNS REGULATIONS AND GENERAL DIRECTIONS (TSRD) 2008 AND TRAFFIC SIGNS MANUAL 2008.

REV	DATE	DRAWN	REV'D	APP'D	NOTES
01	03/04/24	ES	LB	DV	EXISTING ROAD MARKINGS UPDATED
02	06/04/24	ES	LB	DV	SPEED LIMITS HOOFED
10	04/10/24	ES	LB	DV	FIRST ISSUE

DRAWING STATUS  
**FOR INFORMATION**

**NRP**  
 NORMAN ROURKE PRYME

London  
 17 Waterloo Street  
 London, SE1 0UP  
 +44 (0)207 054 7000

Enfield  
 40 Colson Avenue  
 Enfield, EN3 4JF  
 +44 (0)17 987 9803  
 www.nrp.co.uk

CLIENT  
 LONDON BOROUGH OF ENFIELD

PROJECT  
 ENFIELD TOWN TO PONDERS END CYCLE ROUTE

DRAWN	DESIGNED	CHECKED	DATE	APPROVED	DATE
ES	ES	LB	07/02/24	DV	07/02/24

TITLE  
 DETAILED DESIGN - TMO  
 SECTION 2D - PROPOSED LAYOUT  
 SHEET 07 OF 15

SCALE	DRAWING No.	REV
1:200 @A1	10670-NRP-DR-S3-1210-07	2.1

LOGON NAME: ELLY.TREVENION  
 LOCATION: Enfield - proposed cycle route  
 Project Name: Enfield Town to Ponders End Cycle Route  
 Drawing Title: Detailed Design - TMO  
 Drawing No: 10670-NRP-DR-S3-1210-08

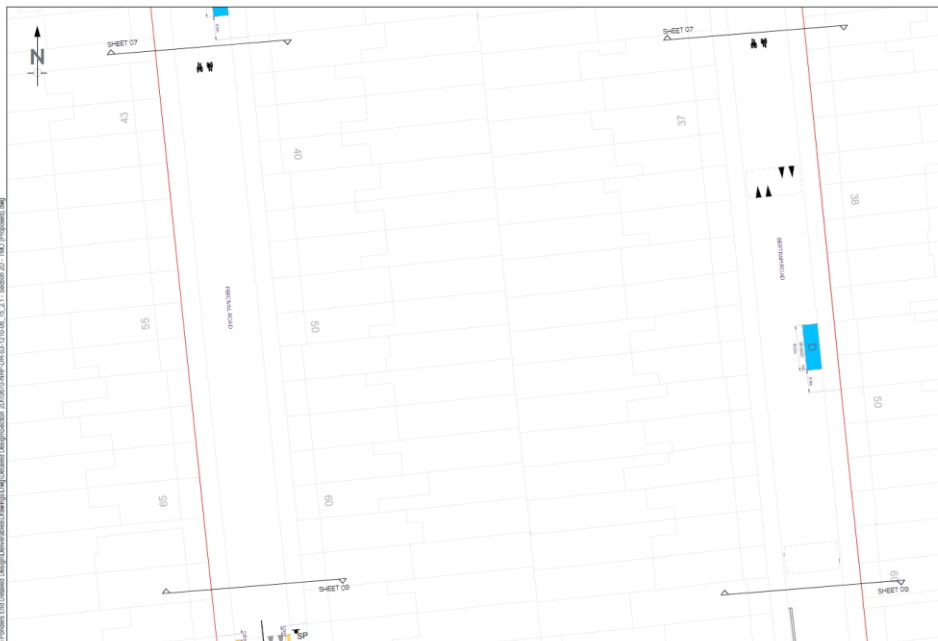

- KEY**
- DISABLED PARKING BAY
  - EXISTING ROAD MARKINGS
  - PROPOSED WHITE ROAD MARKINGS
  - PROPOSED PINKISH YELLOW ROAD MARKINGS
  - PROPOSED NEW SIGN AND POST
  - PROPOSED NEW ILLUMINATED SIGN AND POST
  - SCHEME EXTENTS

	Existing	Proposed	Difference
Disabled parking bay	30 bays (80m)	30 bays (80m)	None
Double yellow line	70.9m	107.6m	+34.7m

- NOTES**
1. ALL DIMENSIONS SHOWN ARE IN METRES UNLESS STATED OTHERWISE.
  2. DO NOT SCALE FROM THIS DRAWING.
  3. THIS DESIGN IS BASED ON A COMBINATION OF TOPOGRAPHICAL SURVEY AND CORDANCE SURVEY. ANY DISCREPANCIES ARE TO BE REPORTED TO SITE ENGINEERS.
  4. ALL ROAD MARKINGS AND SIGNS TO BE IN ACCORDANCE WITH THE TRAFFIC SIGNS REGULATIONS AND GENERAL DIRECTIONS (TSRD) 2008 AND TRAFFIC SIGNS MANUAL 2008.

REV	DATE	DRAWN	REV'D	APP'D	NOTES
01	03/04/24	ES	LB	DV	EXISTING ROAD MARKINGS UPDATED
02	06/04/24	ES	LB	DV	SPEED LIMITS HOOFED
10	04/10/24	ES	LB	DV	FIRST ISSUE

DRAWING STATUS  
**FOR INFORMATION**

**NRP**  
 NORMAN ROURKE PRYME

London  
 17 Waterloo Street  
 London, SE1 0UP  
 +44 (0)207 054 7000

Enfield  
 40 Colson Avenue  
 Enfield, EN3 4JF  
 +44 (0)17 987 9803  
 www.nrp.co.uk

CLIENT  
 LONDON BOROUGH OF ENFIELD

PROJECT  
 ENFIELD TOWN TO PONDERS END CYCLE ROUTE

DRAWN	DESIGNED	CHECKED	DATE	APPROVED	DATE
ES	ES	LB	07/02/24	DV	07/02/24

TITLE  
 DETAILED DESIGN - TMO  
 SECTION 2D - PROPOSED LAYOUT  
 SHEET 08 OF 15

SCALE	DRAWING No.	REV
1:200 @A1	10670-NRP-DR-S3-1210-08	2.1

LOCATION: I:\projects\10670-NRP-DR-S3-1210-09\_15\_21\_Section 2D - TMO (Proposed).dwg

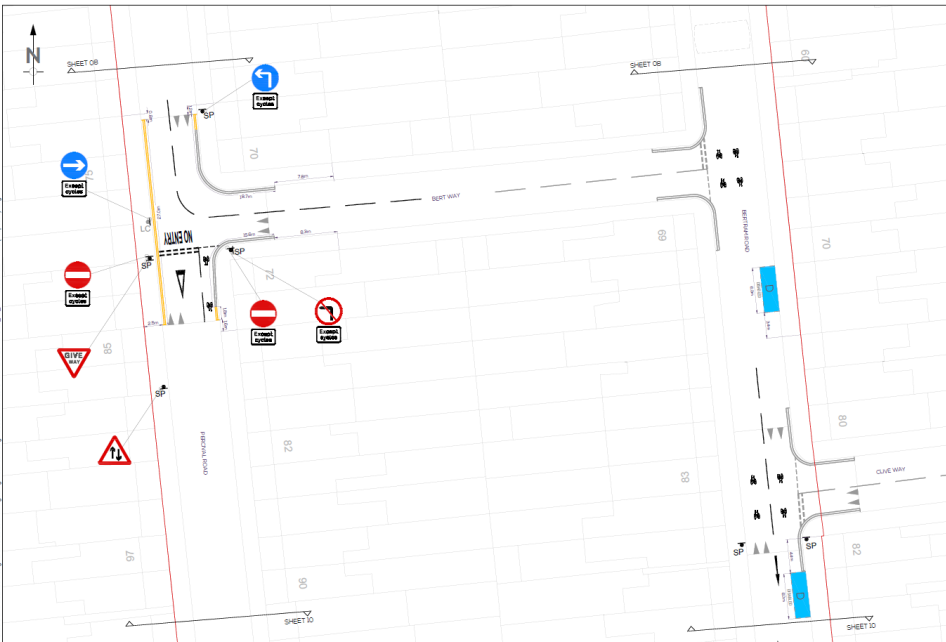

**NOTES**

1. ALL DIMENSIONS SHOWN ARE IN METRES UNLESS STATED OTHERWISE.
2. DO NOT SCALE FROM THIS DRAWING.
3. THIS DESIGN IS BASED ON A COMBINATION OF TOPOGRAPHICAL SURVEY AND ORDINANCE SURVEY. ANY DISCREPANCIES ARE TO BE REPORTED TO SITE ENGINEER.
4. ALL ROAD MARKINGS AND SIGNS TO BE IN ACCORDANCE WITH THE TRAFFIC SIGNS REGULATIONS AND GENERAL DIRECTIONS (TSRD) 2008 AND TRAFFIC SIGNS MANUAL 2018.

REV	DATE	DRAWN	REV'D	APP'D	NOTES
2.1	07/04/24	ES	LB	DV	EXISTING ROAD MARKINGS UPDATED
2.0	30/03/24	ES	LB	DV	SPEED HUMPS MODIFIED
1.0	04/07/24	ES	LB	DV	FIRST ISSUE

**DRAWING STATUS**

**FOR INFORMATION**

**NORMAN ROURKE PRYME**

London: 17 Waterloo Street, London, SE1 0UF, UK | 020 7318 6547 | www.nrpplc.com

Bristol: 4 Colston Avenue, Bristol, BS2 4BT, UK | 0117 927 9810

**CLIENT**  
LONDON BOROUGH OF ENFIELD

**PROJECT**  
ENFIELD TOWN TO PONDERS END CYCLE ROUTE

DRAWN	DESIGNED	REVIEWED	DATE	APPROVED	DATE
ES	ES	LB	07/04/24	DV	07/04/24

**TITLE**  
DETAILED DESIGN - TMO  
SECTION 2D - PROPOSED LAYOUT  
SHEET 09 OF 15

SCALE	DRAWING No	REV
1:200 (A1)	10670-NRP-DR-S3-1210-09	2.1

LOCATION: I:\projects\10670-NRP-DR-S3-1210-09\_15\_21\_Section 2D - TMO (Proposed).dwg

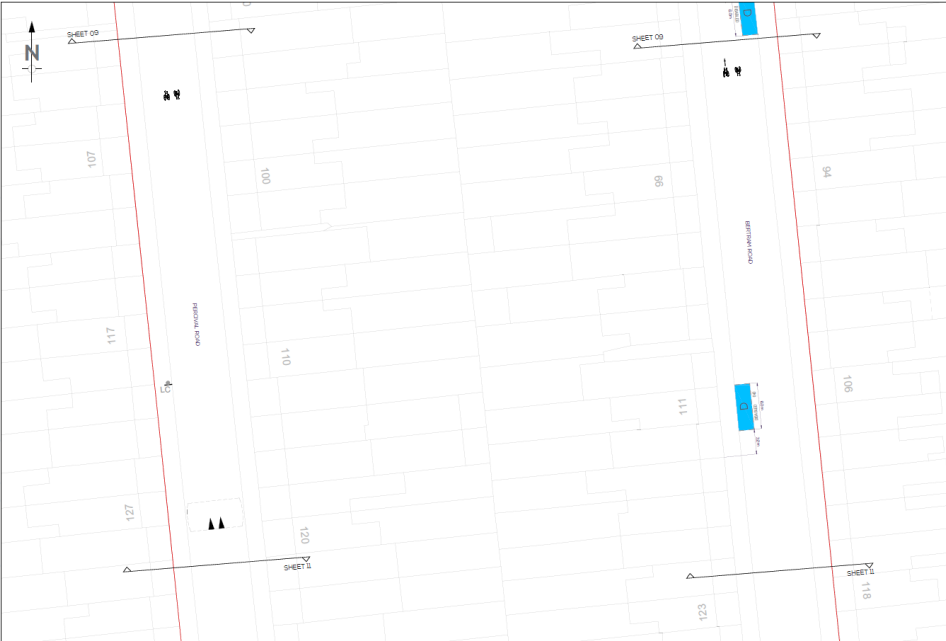

**NOTES**

1. ALL DIMENSIONS SHOWN ARE IN METRES UNLESS STATED OTHERWISE.
2. DO NOT SCALE FROM THIS DRAWING.
3. THIS DESIGN IS BASED ON A COMBINATION OF TOPOGRAPHICAL SURVEY AND ORDINANCE SURVEY. ANY DISCREPANCIES ARE TO BE REPORTED TO SITE ENGINEER.
4. ALL ROAD MARKINGS AND SIGNS TO BE IN ACCORDANCE WITH THE TRAFFIC SIGNS REGULATIONS AND GENERAL DIRECTIONS (TSRD) 2008 AND TRAFFIC SIGNS MANUAL 2018.

REV	DATE	DRAWN	REV'D	APP'D	NOTES
2.1	07/04/24	ES	LB	DV	EXISTING ROAD MARKINGS UPDATED
2.0	30/03/24	ES	LB	DV	SPEED HUMPS MODIFIED
1.0	04/07/24	ES	LB	DV	FIRST ISSUE

**DRAWING STATUS**

**FOR INFORMATION**

**NORMAN ROURKE PRYME**

London: 17 Waterloo Street, London, SE1 0UF, UK | 020 7318 6547 | www.nrpplc.com

Bristol: 4 Colston Avenue, Bristol, BS2 4BT, UK | 0117 927 9810

**CLIENT**  
LONDON BOROUGH OF ENFIELD

**PROJECT**  
ENFIELD TOWN TO PONDERS END CYCLE ROUTE

DRAWN	DESIGNED	REVIEWED	DATE	APPROVED	DATE
ES	ES	LB	07/04/24	DV	07/04/24

**TITLE**  
DETAILED DESIGN - TMO  
SECTION 2D - PROPOSED LAYOUT  
SHEET 10 OF 15

SCALE	DRAWING No	REV
1:200 (A1)	10670-NRP-DR-S3-1210-10	2.1

LOCATION: [unclear] and [unclear] combined project (07/24) (sheet 11 of 15) to [unclear] End Detailed Design (revised) Drawing No: 10670-NRP-DR-S3-1210-11, S. 2.1 - Section 2D - TMO (Proposed) 09/24

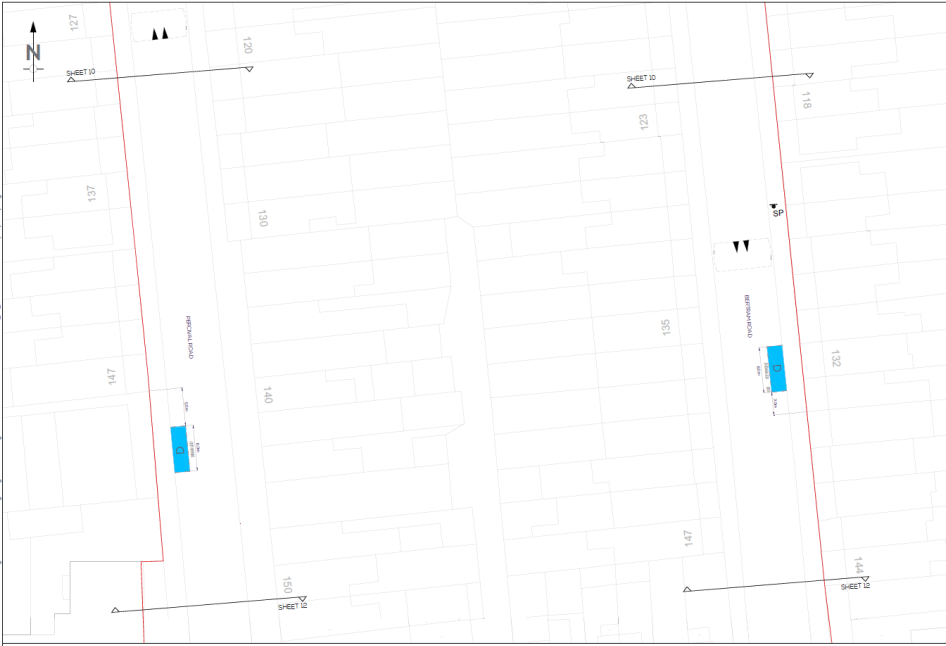

KEY	Existing	Proposed	Difference
DISABLED PARKING BAY	10 bays (60m)	10 bays (60m)	None
EXISTING ROAD MARKINGS	72.9m	107.6m	+34.7m
PROPOSED WHITE ROAD MARKINGS			
PROPOSED PINKISH YELLOW ROAD MARKINGS			
PROPOSED NEW SIGN AND POST			
PROPOSED NEW ILLUMINATED SIGN AND POST			
SCHEME EXTENTS			

NOTES

1. ALL DIMENSIONS SHOWN ARE IN METRES UNLESS STATED OTHERWISE.
2. DO NOT SCALE FROM THIS DRAWING.
3. THIS DESIGN IS BASED ON A COMBINATION OF TOPOGRAPHICAL SURVEY AND ORDINANCE SURVEY. ANY DISCREPANCIES ARE TO BE REPORTED TO SITE ENGINEER.
4. ALL ROAD MARKINGS AND SIGNS TO BE IN ACCORDANCE WITH THE TRAFFIC SIGNS REGULATIONS AND GENERAL DIRECTIONS (TSRD) 2016 AND TRAFFIC SIGNS MANUAL 2018.

REV	DATE	DRAWN	REV'D	APP'D	NOTES
01	07/24	ES	LB	DV	EXISTING ROAD MARKINGS UPDATED
02	06/24	ES	LB	DV	SPEED HUMPS MODIFIED
10	04/24	ES	LB	DV	FIRST ISSUE

DRAWING STATUS  
**FOR INFORMATION**



CLIENT  
LONDON BOROUGH OF ENFIELD

PROJECT  
ENFIELD TOWN TO PONDERS END CYCLE ROUTE

DRAWN	DESIGNED	REVIEWED	DATE	APPROVED	DATE
ES	ES	LB	07/24	DV	07/24

TITLE  
DETAILED DESIGN - TMO  
SECTION 2D - PROPOSED LAYOUT  
SHEET 11 OF 15

SCALE	DRAWING No.	REV
1:200 @A1	10670-NRP-DR-S3-1210-11	21

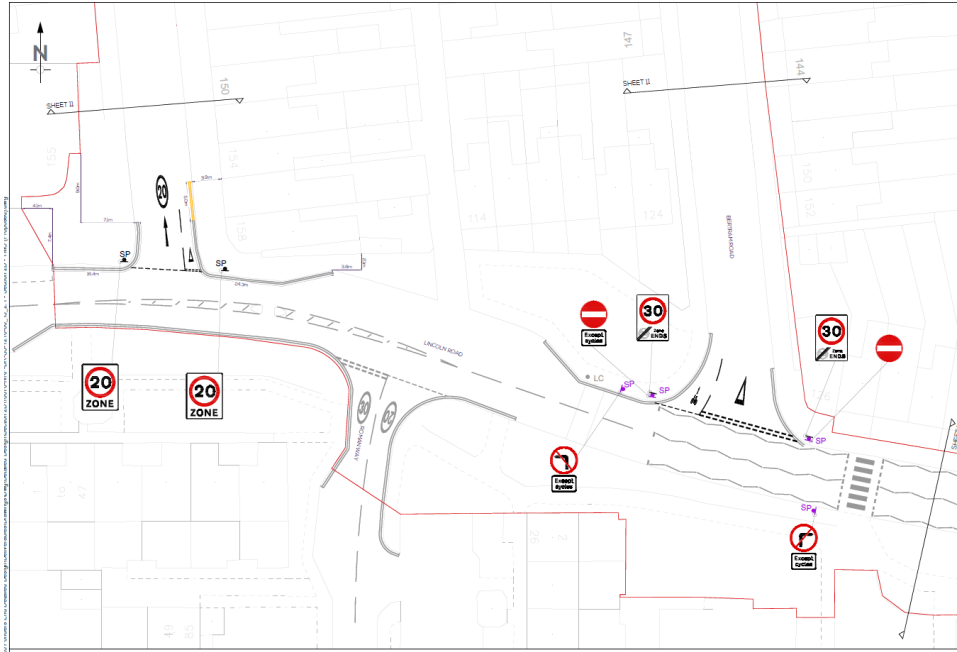

KEY	Existing	Proposed	Difference
DISABLED PARKING BAY	10 bays (60m)	10 bays (60m)	None
EXISTING ROAD MARKINGS	72.9m	107.6m	+34.7m
PROPOSED WHITE ROAD MARKINGS			
PROPOSED PINKISH YELLOW ROAD MARKINGS			
PROPOSED NEW SIGN AND POST			
PROPOSED NEW ILLUMINATED SIGN AND POST			
SCHEME EXTENTS			

NOTES

1. ALL DIMENSIONS SHOWN ARE IN METRES UNLESS STATED OTHERWISE.
2. DO NOT SCALE FROM THIS DRAWING.
3. THIS DESIGN IS BASED ON A COMBINATION OF TOPOGRAPHICAL SURVEY AND ORDINANCE SURVEY. ANY DISCREPANCIES ARE TO BE REPORTED TO SITE ENGINEER.
4. ALL ROAD MARKINGS AND SIGNS TO BE IN ACCORDANCE WITH THE TRAFFIC SIGNS REGULATIONS AND GENERAL DIRECTIONS (TSRD) 2016 AND TRAFFIC SIGNS MANUAL 2018.

REV	DATE	DRAWN	REV'D	APP'D	NOTES
01	07/24	ES	LB	DV	EXISTING ROAD MARKINGS UPDATED
02	06/24	ES	LB	DV	SPEED HUMPS MODIFIED
10	04/24	ES	LB	DV	FIRST ISSUE

DRAWING STATUS  
**FOR INFORMATION**



CLIENT  
LONDON BOROUGH OF ENFIELD

PROJECT  
ENFIELD TOWN TO PONDERS END CYCLE ROUTE

DRAWN	DESIGNED	REVIEWED	DATE	APPROVED	DATE
ES	ES	LB	07/24	DV	07/24

TITLE  
DETAILED DESIGN - TMO  
SECTION 2D - PROPOSED LAYOUT  
SHEET 12 OF 15

SCALE	DRAWING No.	REV
1:200 @A1	10670-NRP-DR-S3-1210-12	21

LOCATION: Enfield/10670-NRP-DR-S3-1210-13, 13.21 - Section 2D - TMO (Proposed) (M)

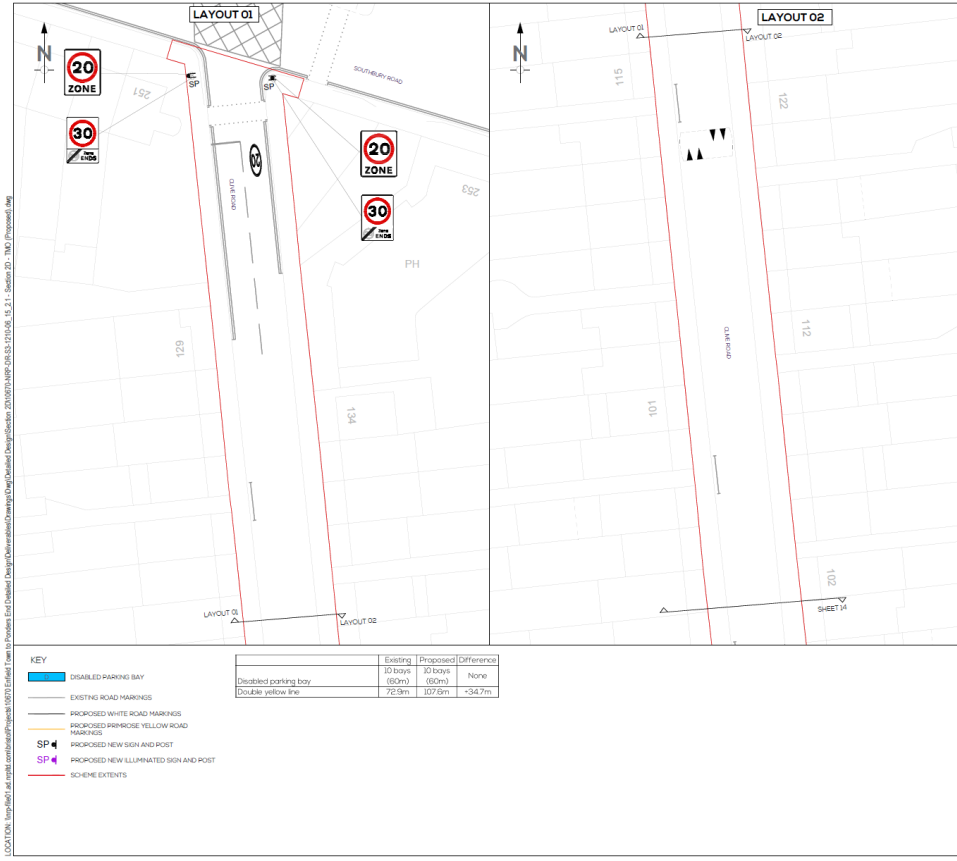

**NOTES**

1. ALL DIMENSIONS SHOWN ARE IN METRES UNLESS STATED OTHERWISE.
2. DO NOT SCALE FROM THIS DRAWING.
3. THIS DESIGN IS BASED ON A COMBINATION OF TOPOGRAPHICAL SURVEY AND ORDINANCE SURVEY. ANY DISCREPANCIES ARE TO BE REPORTED TO SITE ENGINEER.
4. ALL ROAD MARKINGS AND SIGNS TO BE IN ACCORDANCE WITH THE TRAFFIC SIGNS REGULATIONS AND GENERAL DIRECTIONS (TSRD) 2008 AND TRAFFIC SIGNS MANUAL 2008.

REV	DATE	DRAWN	REV'D	APPR'D	NOTES
21	07/01/24	ES	LB	DV	EXISTING ROAD MARKINGS UPDATED
20	06/01/24	ES	LB	DV	SPEED HUMPS MODIFIED
10	04/01/24	ES	LB	DV	FIRST ISSUE

**DRAWING STATUS**

**FOR INFORMATION**

London  
27 Windsor Street  
London, SE1 0DF  
Tel: 0207 764 7390

Sheff  
4 Colston Avenue  
Sheff, S2 4ET  
Tel: 0114 267 8500  
www.nrp.co.uk

**CLIENT**  
LONDON BOROUGH OF ENFIELD

**PROJECT**  
ENFIELD TOWN TO PONDERS END CYCLE ROUTE

DRAWN	DESIGNED	REVIEWED	DATE	APPROVED	DATE
ES	ES	LB	07/01/24	DV	07/01/24

**TITLE**  
DETAILED DESIGN - TMO  
SECTION 2D - PROPOSED LAYOUT  
SHEET 13 OF 15

SCALE	DRAWING No	REV
1:200 (A1)	10670-NRP-DR-S3-1210-13	21

LOCATION: Enfield/10670-NRP-DR-S3-1210-13, 13.21 - Section 2D - TMO (Proposed) (M)

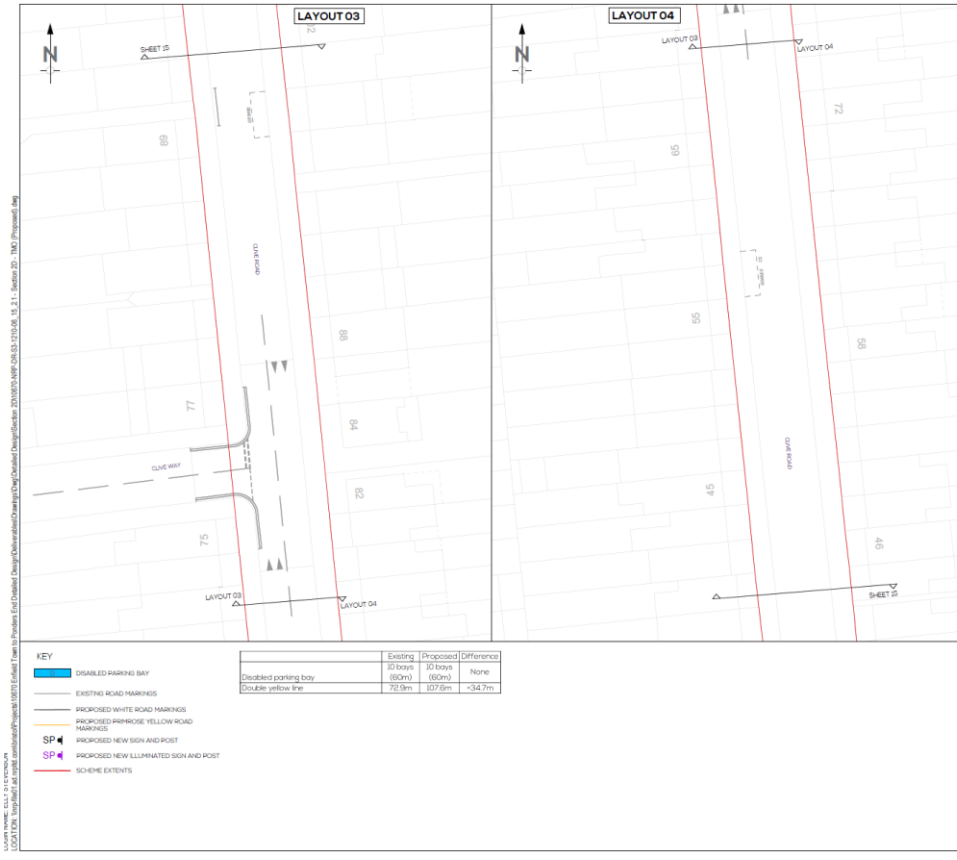

**NOTES**

1. ALL DIMENSIONS SHOWN ARE IN METRES UNLESS STATED OTHERWISE.
2. DO NOT SCALE FROM THIS DRAWING.
3. THIS DESIGN IS BASED ON A COMBINATION OF TOPOGRAPHICAL SURVEY AND ORDINANCE SURVEY. ANY DISCREPANCIES ARE TO BE REPORTED TO SITE ENGINEER.
4. ALL ROAD MARKINGS AND SIGNS TO BE IN ACCORDANCE WITH THE TRAFFIC SIGNS REGULATIONS AND GENERAL DIRECTIONS (TSRD) 2008 AND TRAFFIC SIGNS MANUAL 2008.

REV	DATE	DRAWN	REV'D	APPR'D	NOTES
21	07/01/24	ES	LB	DV	EXISTING ROAD MARKINGS UPDATED
20	06/01/24	ES	LB	DV	SPEED HUMPS MODIFIED
10	04/01/24	ES	LB	DV	FIRST ISSUE

**DRAWING STATUS**

**FOR INFORMATION**

London  
27 Windsor Street  
London, SE1 0DF  
Tel: 0207 764 7390

Sheff  
4 Colston Avenue  
Sheff, S2 4ET  
Tel: 0114 267 8500  
www.nrp.co.uk

**CLIENT**  
LONDON BOROUGH OF ENFIELD

**PROJECT**  
ENFIELD TOWN TO PONDERS END CYCLE ROUTE

DRAWN	DESIGNED	REVIEWED	DATE	APPROVED	DATE
ES	ES	LB	07/01/24	DV	07/01/24

**TITLE**  
DETAILED DESIGN - TMO  
SECTION 2D - PROPOSED LAYOUT  
SHEET 14 OF 15

SCALE	DRAWING No	REV
1:200 (A1)	10670-NRP-DR-S3-1210-14	21

LAYOUT NAME: LLS 131 ENFIELD  
 LOCATION: Town of Enfield, London Borough of Enfield  
 PROJECT: ENFIELD TOWN TO PONDERS END CYCLE ROUTE  
 DRAWING NO: 10670-NRP-DR-S3-1210-15  
 DATE: 07/25/24  
 SCALE: 1:200 @A1  
 DRAWING TITLE: SECTION 2D - PROPOSED LAYOUT  
 SHEET 15 OF 15  
 PROJECT: ENFIELD TOWN TO PONDERS END CYCLE ROUTE  
 CLIENT: LONDON BOROUGH OF ENFIELD  
 DRAWING STATUS: FOR INFORMATION  
 NRP  
 NORMAN ROURKE PRYME  
 London: 57 Waterloo Street, London, EC3R 3DP, +44 (0)207 654 7800  
 Bristol: 4 Colston Avenue, Bristol, BS1 4BT, +44 (0)127 387 8980  
 www.nrpuk.com



**KEY**

- █ DISABLED PARKING BAY
- EXISTING ROAD MARKINGS
- PROPOSED WHITE ROAD MARKINGS
- PROPOSED FIRM-GRADE YELLOW ROAD MARKINGS
- SP █ PROPOSED NEW SIGN AND POST
- SP █ PROPOSED NEW ILLUMINATED SIGN AND POST
- SCHEME EXTENTS

	Existing	Proposed	Difference
Disabled parking bay	30 bays (60m)	30 bays (60m)	None
Double yellow line	72.9m	107.6m	+34.7m

**NOTES**

1. ALL DIMENSIONS SHOWN ARE IN METRES UNLESS STATED OTHERWISE.
2. DO NOT SCALE FROM THIS DRAWING.
3. THIS DESIGN IS BASED ON A COMBINATION OF TOPOGRAPHICAL SURVEY AND ORDINANCE SURVEY. ANY DISCREPANCIES ARE TO BE RESOLVED TO THE ENGINEER.
4. ALL ROAD MARKINGS AND SIGNS TO BE IN ACCORDANCE WITH THE TRAFFIC SIGNS REGULATIONS AND GENERAL DIRECTIONS (TSR60) 2006 AND TRAFFIC SIGNS MANUAL 2008.

REV	DATE	DRAWN	REV'D	APP'D	NOTES
2.1	07/25/24	ES	LB	CV	EXISTING ROAD MARKINGS UPDATED
2.0	06/04/24	ES	LB	DV	SPEED LIMITS MODIFIED
1.0	04/03/24	ES	LB	DV	FIRST ISSUE

**DRAWING STATUS**

FOR INFORMATION

NRP

NORMAN ROURKE PRYME

**CLIENT**  
LONDON BOROUGH OF ENFIELD

**PROJECT**  
ENFIELD TOWN TO PONDERS END CYCLE ROUTE

DESIGN	DESIGNED	REVISION	DATE	APPROVED	DATE
ES	ES	LB	07/25/24	DV	07/25/24

**TITLE**  
DETAILED DESIGN - TMO  
SECTION 2D - PROPOSED LAYOUT  
SHEET 15 OF 15

SCALE 1:200 @A1	DRAWING NO. 10670-NRP-DR-S3-1210-15	REV 2.1
--------------------	--	------------

A1